

# Disrupting Injustices

- prevent anything that prevents individuals from **learning**

- accessible funding

- after-school programs

- changing the norms of who an

**Building "Working With, Not For"**

**Into Design Studio Curriculum**

educator is (the faces associated with educators)

Saskia van Kampen

Assistant Professor, Visual Communication Design

San Francisco State University

with

Cheryl Giraudy

Assistant Professor, Inclusive Design

OCAD University, Toronto, Canada

# Context

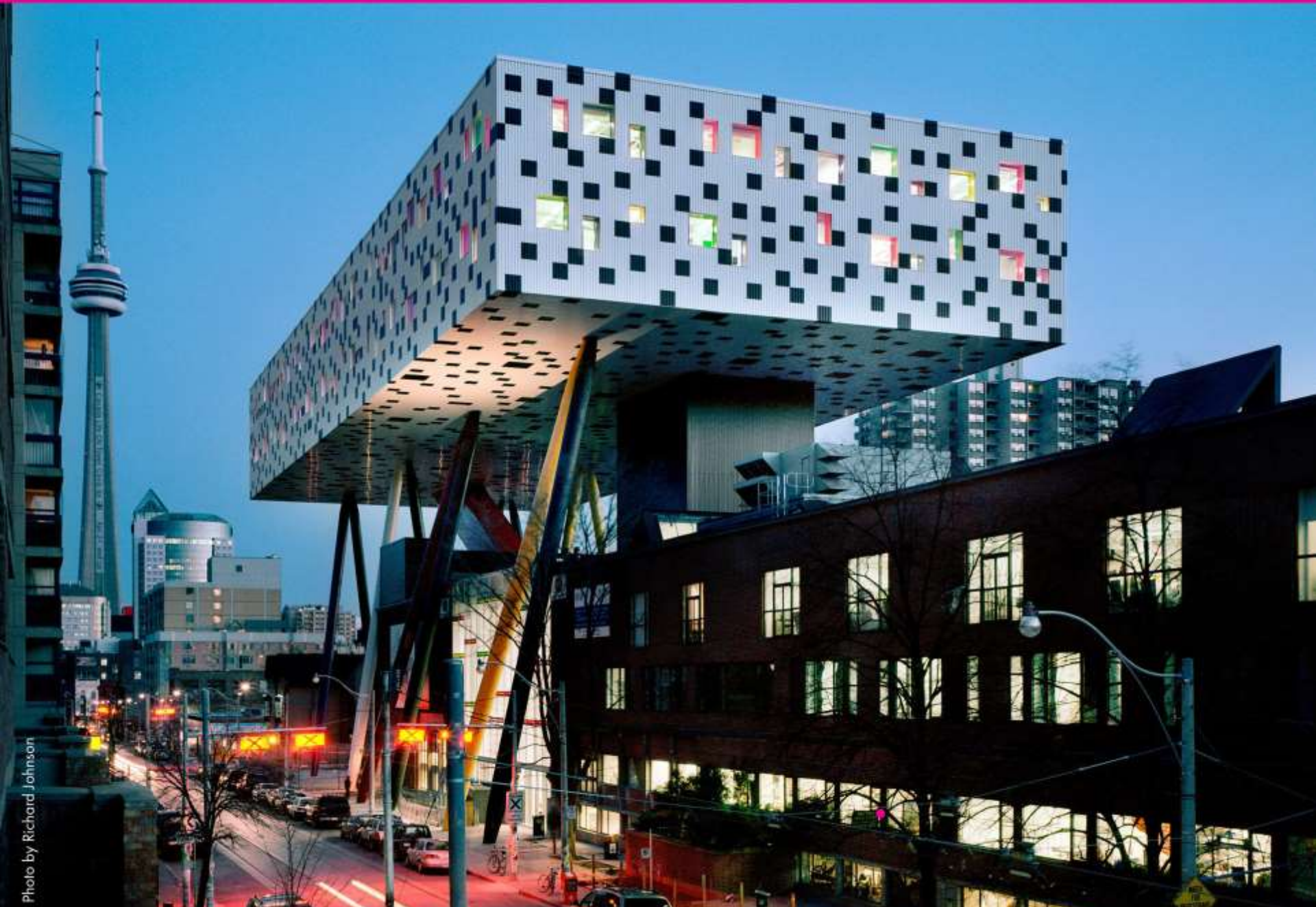

# Context

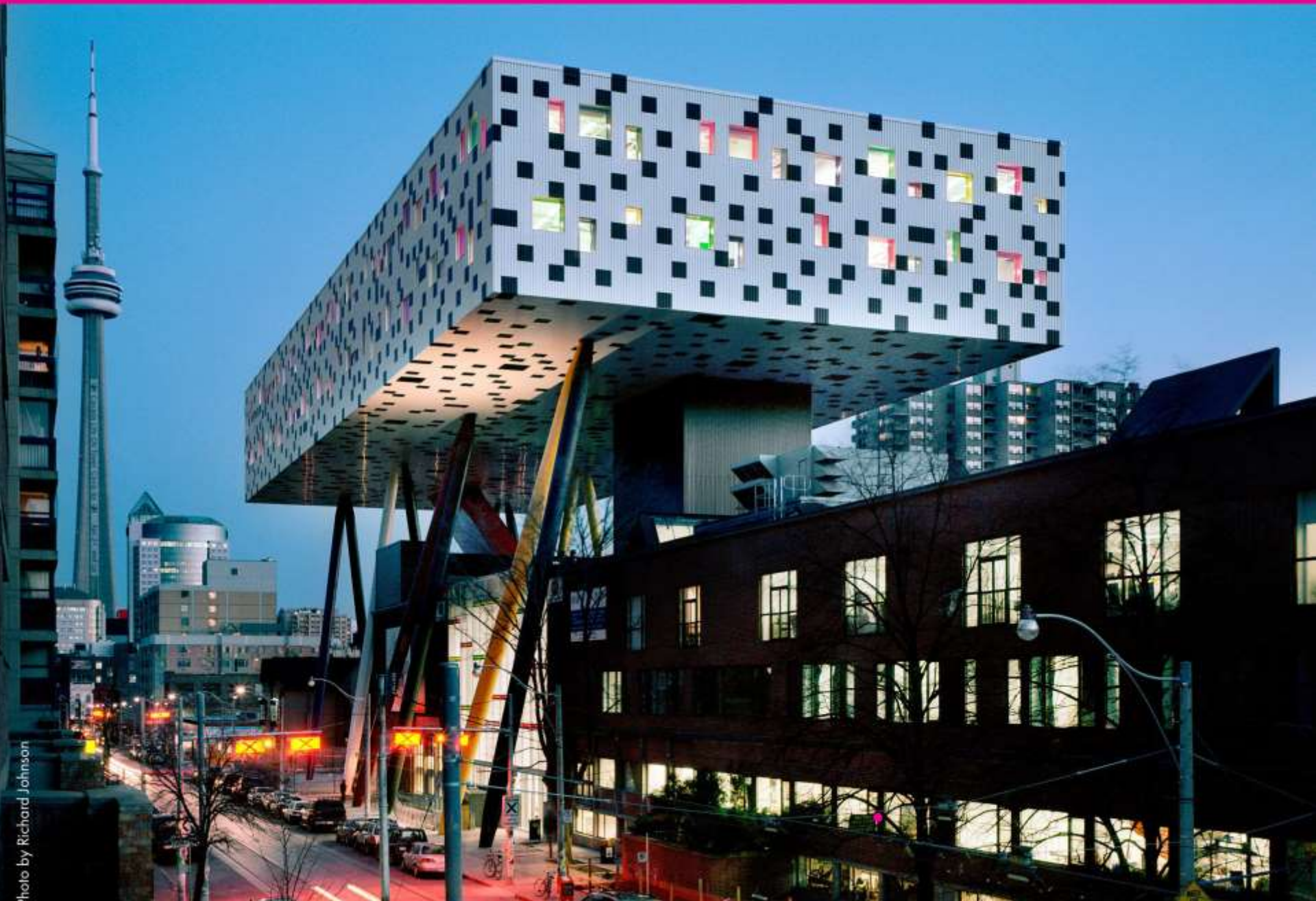

# The Project

## Design Wo/ManiFesT.O.

creating new ideas for Toronto



# The Project

## Design Wo/ManiFesT.O. creating new ideas for Toronto



# The Project

## Design Wo/ManiFesT.O. creating new ideas for Toronto



# Unexpected Discovery

## **Design Ethics:**

**Research protocols that are typically put into place through institutions that are meant to protect human participants and how these same measures need to be applied where community members, who may or may not be participants in a research study, are directly affected by the work that is being created.**

# Unexpected Discovery

## **Design Ethics:**

**Research protocols that are typically put into place through institutions that are meant to protect human participants and how these same measures need to be applied where community members, who may or may not be participants in a research study, are directly affected by the work that is being created.**



**DESIGNING**

~~**FOR**~~

**with**

# Unexpected Discovery

## **Design Ethics:**

**Research protocols that are typically put into place through institutions that are meant to protect human participants and how these same measures need to be applied where community members, who may or may not be participants in a research study, are directly affected by the work that is being created.**

# Unexpected Discovery

## **Design Ethics:**

**Research protocols that are typically put into place through institutions that are meant to protect human participants and how these same measures need to be applied where community members, who may or may not be participants in a research study, are directly affected by the work that is being created.**

# Unexpected Discovery

## Design Ethics:

Research protocols that are typically put into place through institutions that are meant to protect human participants and how these same measures need to be applied where community members, who may or may not be participants in a research study, are directly affected by the work that is being created.

# Unexpected Discovery

## **Design Ethics:**

**Research protocols that are typically put into place through institutions that are meant to protect human participants and how these same measures need to be applied where community members, who may or may not be participants in a research study, are directly affected by the work that is being created.**

# Unexpected Discovery

## **Design Ethics:**

**Research protocols that are typically put into place through institutions that are meant to protect human participants and how these same measures need to be applied where community members, who may or may not be participants in a research study, are directly affected by the work that is being created.**

**Without direct contact with communities, students will not be able to build empathy or deep understanding of the community they are researching nor develop skills to locate and/or allow for bottom-up strategies.**

**Without direct contact with communities, students will not be able to build empathy or deep understanding of the community they are researching nor develop skills to locate and/or allow for bottom-up strategies.**



**Without direct contact with communities, students will not be able to build empathy or deep understanding of the community they are researching nor develop skills to locate and/or allow for bottom-up strategies.**

**Without direct contact with communities, students will not be able to build empathy or deep understanding of the community they are researching nor develop skills to locate and/or allow for bottom-up strategies.**

## Gaps

**Without direct contact with communities, students will not be able to build empathy or deep understanding of the community they are researching nor develop skills to locate and/or allow for bottom-up strategies.**

**Without direct contact with communities, students will not be able to build empathy or deep understanding of the community they are researching nor develop skills to locate and/or allow for bottom-up strategies.**



**design has been acknowledged by public agencies and NGOs as one of the tools to tackle the complexity of social issues** *(Emilson, et al. 2011)*



**design has been acknowledged by public agencies and NGOs as one of the tools to tackle the complexity of social issues** *(Emilson, et al. 2011)*

Youth Workshop

# Creative Practice & Protest

ORGANIZE ADVOCATE CREATE  
FOR RACIAL SOCIAL  
& CULTURAL EQUITY







# Youth Workshop

## VISION ZERO OR ZERO VISION?

The City of Toronto is spending 44% of our transportation capital work budget on the Gardiner Expressway which is used only 3% of Toronto's population. A mere 3% is being invested in Vision Zero initiatives to make our streets safer.

#MobilityJusticeTO

## VISION ZERO OR ZERO VISION?

200 people have been killed on our city's streets since Toronto City Council approved Vision Zero in 2016 and committed to zero traffic deaths. How many more of us need to die before we see concrete action?

#MobilityJusticeTO

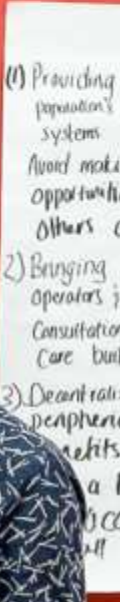

# Youth Workshop

## VISION ZERO OR ZERO VISION?

The City of Toronto is spending 44% of our transportation capital work budget on the Gardiner Expressway which is used only 3% of Toronto's population. A mere 3% is being invested in Vision Zero initiatives to make our streets safer.

#MobilityJusticeTO

## VISION ZERO OR ZERO VISION?

200 people have been killed on our city's streets since Toronto City Council approved Vision Zero in 2016 and committed to zero traffic deaths. How many more of us need to die before we see concrete action?

#MobilityJusticeTO

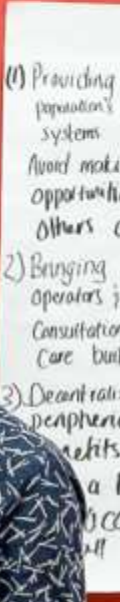

# Participation in placemaking

Goals  
→ Designated  
→ Getting more  
people to access  
their centre  
→ Spreading  
the message

Welcome Home

## The Welcome Home Floor Plan

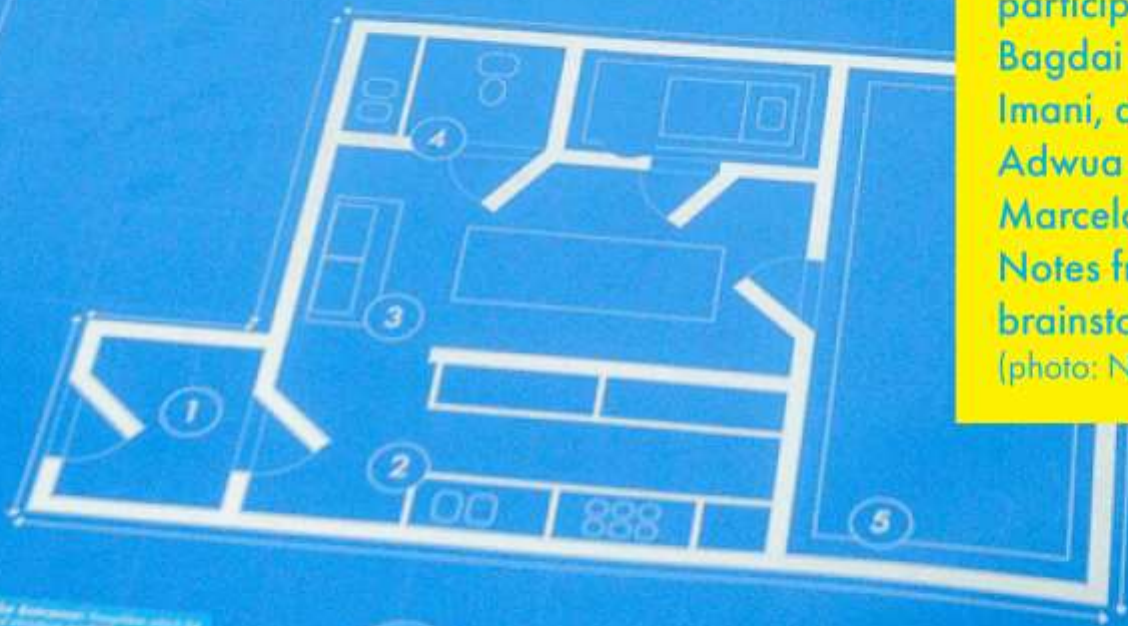

1

The Entrance is a space which is used for people to enter the centre and to receive support and advice.

2

The Kitchen is a space which is used for people to prepare food and to receive support and advice.

3

The Living Room is a space which is used for people to relax and to receive support and advice.

4

The Workshop is a space which is used for people to learn and to receive support and advice.

The Bedroom is a space which is used for people to rest and to receive support and advice.

Floor plan for Welcome Home a mobile resource centre for home-insecure individuals by youth participants: Rahul Bagdai and Neela Imani, and mentors: Adwua Afful and Marcela Cordero. Notes from morning brainstorm session. (photo: Nick Sagar)

## Assumptions, Limitations, and Questions

**Without direct contact with communities, students will not be able to build empathy or deep understanding of the community they are researching nor develop skills to locate and/or allow for bottom-up strategies.**

## Assumptions, Limitations, and Questions

**Without direct contact with communities, students will not be able to build empathy or deep understanding of the community they are researching nor develop skills to locate and/or allow for bottom-up strategies.**

## Assumptions, Limitations, and Questions

**Without direct contact with communities, students will not be able to build empathy or deep understanding of the community they are researching nor develop skills to locate and/or allow for bottom-up strategies.**

## Assumptions, Limitations, and Questions

**Without direct contact with communities, students will not be able to build empathy or deep understanding of the community they are researching nor develop skills to locate and/or allow for bottom-up strategies.**

## Assumptions, Limitations, and Questions

**Without direct contact with communities, students will not be able to build empathy or deep understanding of the community they are researching nor develop skills to locate and/or allow for bottom-up strategies.**



## Conclusion



**Too frequently, educational research is conceived and designed in isolation from practice. We need more collaborative approaches that engage formal and informal educators, researchers, and students to jointly discuss and design opportunities for improving STEM education.** *(Clark, 2015)*

## Conclusion



**Too frequently, educational research is conceived and designed in isolation from practice. We need more collaborative approaches that engage formal and informal educators, researchers, and students to jointly discuss and design opportunities for improving STEM education.** *(Clark, 2015)*

## Conclusion



**Too frequently, educational research is conceived and designed in isolation from practice. We need more collaborative approaches that engage formal and informal educators, researchers, and students to jointly discuss and design opportunities for improving STEM education.** *(Clark, 2015)*

# References

- Altay, B., & Demirkan, H. 2014. Inclusive design: developing students' knowledge and attitude through empathic modelling. *International Journal of Inclusive Education*, 8, 2, 196-217.
- Amatullo, M. (2020). Caring for what we leave behind: Ethical considerations in social innovation pedagogy. In L. Scherling, & A. DeRosa, *Ethics in Design and Communication: Critical Perspectives* (pp. 165-176). London: Bloomsbury.
- Anderson, T., & Milbrandt, M. 2005. *Art for Life: Authentic Instruction in Art*. New York: McGraw-Hill.
- Ballantine, J., Lewy, M., Martin, A., Munro, I., & Powell, P. 2008. An ethical perspective on information systems evaluation. *International Journal of Agile Management Systems*, 2, 3, 23-3241.
- Baum, F., MacDougall, C., & Smith, D. 2006. Glossary: Participatory action research. *Journal of Epidemiol Community Health*, 60, 854-857.
- Bieling, T., Joost, G., & Müller, A. (2010, Accessed 15 04 2020). Collaborative Potential: Designing Coexistence in Urban Context. Retrieved from *VIRUS*. <http://www.nomads.usp.br/virus/virus04/?sec=4&item=2&lang=en>
- Björgvinsson, E., Pelle, E., & Per-Anders, H. (2012, June-September). Agonistic participatory design: working with marginalised social movements. *CoDesign*, 8, 2-3, 127-144.
- Chick, A. 2012. *Design for social innovation: Emerging principles and approaches*. *Iridescent*, 2, 1, 52-64.
- Clark, H. 2015. What We Do. (University of Washington Institute for Science + Math Education.) Retrieved January 2020, from Research + Practice Collaboratory: <http://researchandpractice.org/>
- Day, C. 2003. *Consensus design: Socially inclusive process*. Burlington, MA: Architectural Press.
- Edizioni, M., & Manzini, E. 2008. *Collaborative services: Social innovation and design for sustainability*. Milan: Edizioni POLIdesign.
- Emilson, A., Seravalli, A., & Hillgren, P.-A. 2011. Dealing with dilemmas: Participatory approaches in Design for Social Innovation. *Swedish Design Research Journal*, 23-29.
- Estêvão, S. V. 2020. Freedom and communication design: An ethical approach. In L. Scherling, & A. DeRosa, *Ethics In Design And Communication: Critical Perspectives* (pp. 102-110). London: Bloomsbury.
- Gillis, C. 1992. *The Community as Classroom: Integrating School and Community through Language Arts*. Portsmouth: Boyton/Cook.
- Giraudy, C., & Billark, A. 2011. *Inclusive Wayfinding in the Social Housing Context*. Toronto: OCAD University.
- Goldbard, A. 2006. *New Creative Community: The Art of Cultural Development*. Oakland: New Village press.
- Gray, D. E. 2004. *Doing Research in the Real World*. London: Sage.
- Hulchanski, J. D. 2007. *Three Cities Within Toronto: Income Polarization Among Toronto's neighbourhoods, 1970-2005*. Toronto: University of Toronto.
- Inguva, P., Lee-Lane, D., Teck, A., Anabaraonye, B., Chen, W., Shah, U. V., & Brechtelsbauer, C. 2018. Advancing experiential learning through participatory design. *Education for Chemical Engineers*, 25, 16-21.
- Jones, B. L., & Jones, J. S. (2020, April 5). Gov. Cuomo is wrong, covid-19 is anything but an equalizer The pandemic will strike the poor harder around the globe. *The Washington Post*.
- Kretzmann, J. P., & McKnight, J. L. 1993. *Building Communities from the Inside Out: A Path Toward Finding and Mobilizing a Community's Assets*. Evanston: Institute for Policy Research.
- Lawton, P. H. 2014. The role of art education in cultivating community and leadership through creative collaboration. *Visual Inquiry: Learning & Teaching Art*, 3, 3, 421-436.
- Manzini, E., & Meroni, A. 2007. Emerging user demands for sustainable solutions EMUDE. In W. d. Ralf Michel, *Design Research Now: Essays and Selected Projects*. ProQuest.
- Margolin, V. M. 2002. A "social model" of design: Issues of practice and research. *Design Issues*, 18, 4, 24-30.

# References

- Altay, B., & Demirkan, H. 2014. Inclusive design: developing students' knowledge and attitude through empathic modelling. *International Journal of Inclusive Education*, 8, 2, 196-217.
- Amatullo, M. (2020). Caring for what we leave behind: Ethical considerations in social innovation pedagogy. In L. Scherling, & A. DeRosa, *Ethics in Design and Communication: Critical Perspectives* (pp. 165-176). London: Bloomsbury.
- Anderson, T., & Milbrandt, M. 2005. *Art for Life: Authentic Instruction in Art*. New York: McGraw-Hill.
- Ballantine, J., Levy, M., Martin, A., Munro, I., & Powell, P. 2000. An ethical perspective on information systems evaluation. *International Journal of Agile Management Systems*, 2, 3, 23-3241.
- Baum, F., MacDougall, C., & Smith, D. 2006. Glossary: Participatory action research. *Journal of Epidemiol Community Health*, 60, 854-857.
- Bieling, T., Joost, G., & Müller, A. (2010, Accessed 15 04 2020). Collaborative Potential: Designing Coexistence in Urban Context. Retrieved from *VIRUS*: <http://www.nomads.usp.br/virus/virus04/?sec=4&item=2&lang=en>
- Björgvinsson, E., Pelle, E., & Per-Anders, H. (2012, June-September). Agonistic participatory design: working with marginalised social movements. *CoDesign*, 8, 2-3, 127-144.
- Chick, A. 2012. *Design for social innovation: Emerging principles and approaches*. *Iridescent*, 2, 1, 52-64.
- Clark, H. 2015. What We Do. (University of Washington Institute for Science + Math Education.) Retrieved January 2020, from Research + Practice Collaboratory: <http://researchandpractice.org/>
- Day, C. 2003. *Consensus design: Socially inclusive process*. Burlington, MA: Architectural Press.
- Edizioni, M., & Manzini, E. 2008. *Collaborative services: Social innovation and design for sustainability*. Milan: Edizioni POLIdesign.
- Emilson, A., Seravalli, A., & Hillgren, P.-A. 2011. Dealing with dilemmas: Participatory approaches in Design for Social Innovation. *Swedish Design Research Journal*, 23-29.
- Estêvão, S. V. 2020. Freedom and communication design: An ethical approach. In L. Scherling, & A. DeRosa, *Ethics In Design And Communication: Critical Perspectives* (pp. 102-110). London: Bloomsbury.
- Gillis, C. 1992. *The Community as Classroom: Integrating School and Community through Language Arts*. Portsmouth: Boyton/Cook.
- Giraudy, C., & Billark, A. 2011. *Inclusive Wayfinding in the Social Housing Context*. Toronto: OCAD University.
- Goldbard, A. 2006. *New Creative Community: The Art of Cultural Development*. Oakland: New Village press.
- Gray, D. E. 2004. *Doing Research in the Real World*. London: Sage.
- Hulchanski, J. D. 2007. *Three Cities Within Toronto: Income Polarization Among Toronto's neighbourhoods, 1970-2005*. Toronto: University of Toronto.
- Inguva, P., Lee-Lane, D., Teck, A., Anabaraonye, B., Chen, W., Shah, U. V., & Brechtelsbauer, C. 2018. Advancing experiential learning through participatory design. *Education for Chemical Engineers*, 25, 16-21.
- Jones, B. L., & Jones, J. S. (2020, April 5). Gov. Cuomo is wrong, covid-19 is anything but an equalizer The pandemic will strike the poor harder around the globe. *The Washington Post*.
- Kretzmann, J. P., & McKnight, J. L. 1993. *Building Communities from the Inside Out: A Path Toward Finding and Mobilizing a Community's Assets*. Evanston: Institute for Policy Research.
- Lawton, P. H. 2014. The role of art education in cultivating community and leadership through creative collaboration. *Visual Inquiry: Learning & Teaching Art*, 3, 3, 421-436.
- Manzini, E., & Meroni, A. 2007. Emerging user demands for sustainable solutions EMUDE. In W. d. Ralf Michel, *Design Research Now: Essays and Selected Projects*. ProQuest.
- Margolin, V. M. 2002. A "social model" of design: Issues of practice and research. *Design Issues*, 18, 4, 24-30.